

PLAN GARLINGTON TOWN PLANNING DEVELOPMENT ZONES

of

SCALE 1:7500 (A3)

- CENTRAL
- SPECIAL RESIDENTIAL A
- SPECIAL RESIDENTIAL B
- SPECIAL RESIDENTIAL C
- SPECIAL RESIDENTIAL D
- SPECIAL RESIDENTIAL E
- AGRICULTURE
- INSTITUTION
- WAREHOUSE

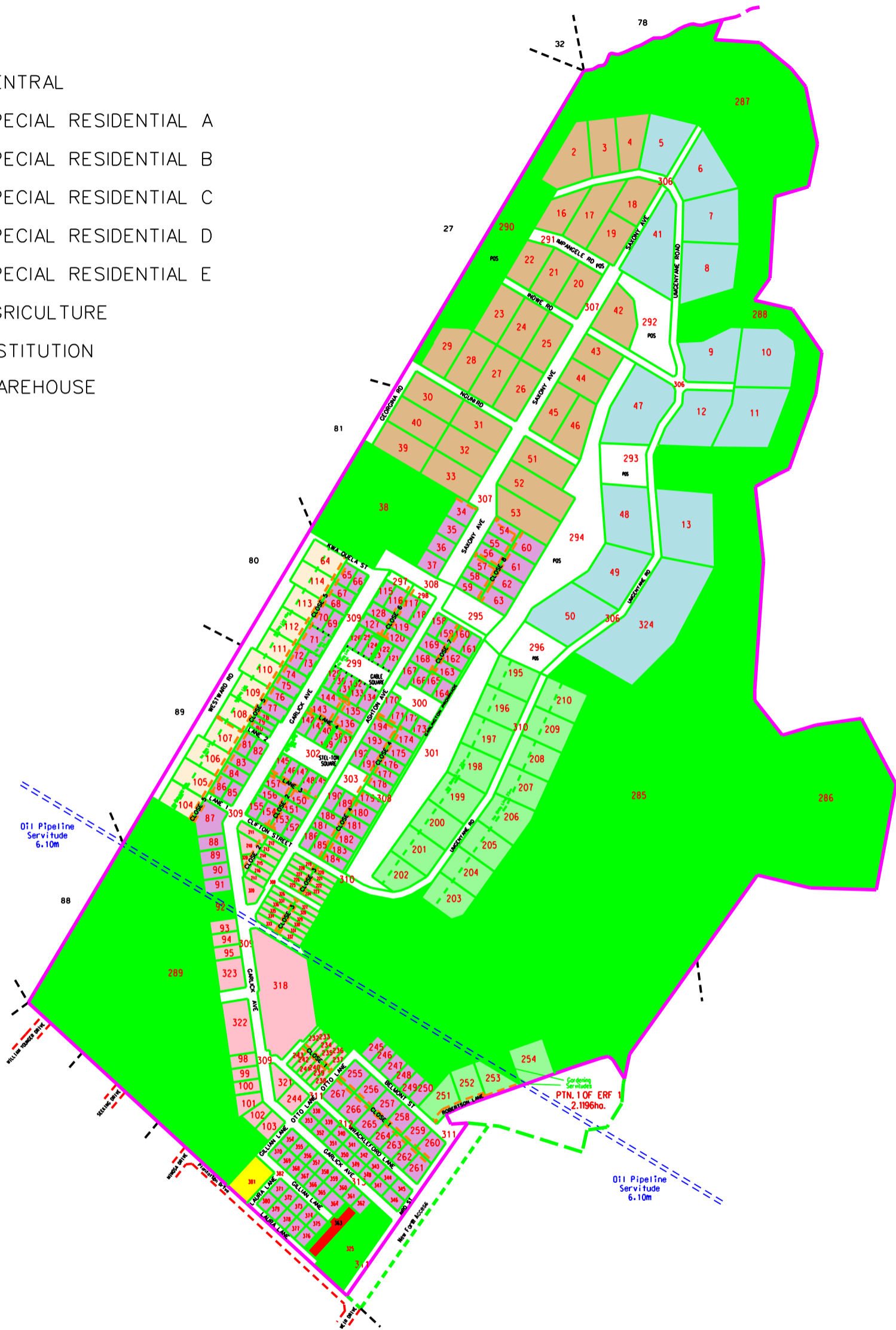

PREPARED BY

GREENE LAND

LAND AND PLANNING LAW
SUBDIVISIONAL CONSENT

400 Old Howick Rd, Quarry Office Park

P.O. Box 11

HILTON 3245

Tel. +27-33-343 4473 Fax +27-33-343 4201

File No.

212

PLAN No.

212TP
DEVELOPMENT

DATE

March 2009