

# PLAN GARLINGTON TOWN PLANNING LAND USE ZONES

of

SCALE 1:7500 (A3)

- CENTRAL ZONE
- RESIDENTIAL ZONE
- WAREHOUSE ZONE
- INSTITUTION ZONE
- AGRICULTURE ZONE
- PRIVATE OPEN SPACE ZONE

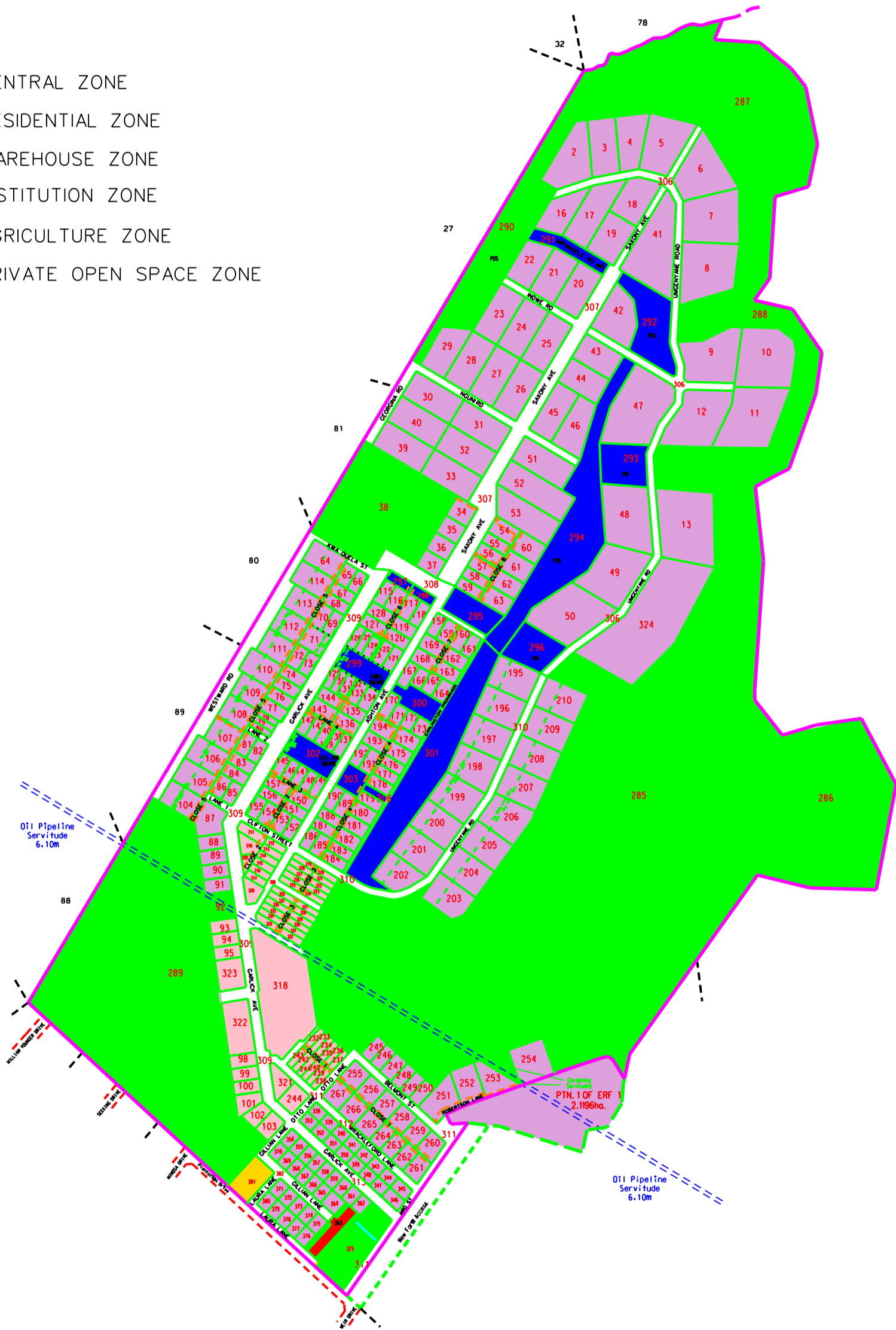

PREPARED BY

**GREENE LAND**

LAND AND PLANNING LAW  
SUBDIVISIONAL CONSENT

400 Old Howick Rd, Quarry Office Park

P.O. Box 11

HILTON 3245

Tel. +27-33-343 4473 Fax +27-33-343 4201

File No.

212

PLAN No.

212 TP ZONES

DATE

MARCH 2009